

3J

Mechanical Tee Threaded Outlet

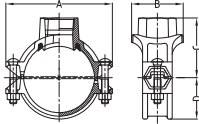

Nominal Size mm/in	Pipe O.D. mm/in	Working Pressure PSI/MPa	Hole Dia mm/in +1.6,0/+0.063,0	Dimensions				Bolt Size mm/in	Certificate
				A mm/in	B mm/in	C mm/in	D mm/in		
25X10 1X3/8	33.7X17.2 1.315X0.677	300 2.07	23.5 0.92	86 3.38	46 1.81	26 1.02	24.5 0.96	M8X30 —	
25X15 1X1/2	33.7X21.3 1.315X0.825	300 2.07	23.5 0.92	86 3.38	46 1.81	26 1.02	24.5 0.96	M8X30 VdS	
25X20 1X3/4	33.7X26.9 1.315X1.050	300 2.07	23.5 0.92	86 3.38	52 2.05	41 1.61	24.5 0.96	M8X30 VdS	
25X25 1X1	33.7X33.7 1.315X1.315	300 2.07	23.5 0.92	86 3.38	57 2.24	45 1.77	24.5 0.96	M8X30 VdS	
32X10 11/4X3/8	42.4X17.2 1.660X0.677	300 2.07	30 1.18	95.5 3.76	53 2.09	32 1.26	29 1.14	M10X35 —	
32X15 11/4X1/2	42.4X21.3 1.660X0.825	300 2.07	30 1.18	95.5 3.76	57 2.24	32 1.26	29 1.14	M10X35 VdS	
32X20 11/4X3/4	42.4X26.9 1.660X1.050	300 2.07	30 1.18	95.5 3.76	57 2.24	32 1.26	29 1.14	M10X35 VdS	
32X25 11/4X1	42.4X33.7 1.660X1.315	300 2.07	30 1.18	95.5 3.76	57 2.24	32 2.09	29 1.14	M10X35 VdS	
40X10 11/2X3/8	48.3X17.2 1.900X0.677	300 2.07	30 1.18	101.5 3.99	53 2.09	34 1.34	32.5 1.28	M10X35 —	
40X15 11/2X1/2	48.3X21.3 1.900X0.825	300 2.07	30 1.18	101.5 3.99	57 2.24	35.5 1.40	32.5 1.28	M10X35 VdS	
40X20 11/2X3/4	48.3X26.9 1.900X1.050	300 2.07	30 1.18	101.5 3.99	57 2.24	47.5 1.87	32.5 1.28	M10X35 VdS	
40X25 11/2X1	48.3X33.7 1.900X1.315	300 2.07	30 1.18	101.5 3.99	57 2.24	56 2.20	32.5 1.28	M10X35 VdS	
50 × 10 2 × 3/8	60.3 × 17.2 2.375 × 0.677	300 2.07	38 1.50	116 4.57	68 2.68	44 1.73	39 1.54	3/8 × 55 M10X57	
50 × 15 2 × 1/2	60.3 × 21.3 2.375 × 0.825	300 2.07	38 1.50	116 4.57	68 2.68	60 2.36	39 1.54	3/8 × 55 M10X57	
50 × 20 2 × 3/4	60.3 × 26.9 2.375 × 1.050	300 2.07	38 1.50	116 4.57	68 2.68	60 2.36	39 1.54	3/8 × 55 M10X57	
50 × 25 2 × 1	60.3 × 33.7 2.375 × 1.315	300 2.07	38 1.50	116 4.57	68 2.68	60 2.36	39 1.54	3/8 × 55 M10X57	
50 × 32 2 × 1 1/4	60.3 × 42.4 2.375 × 1.660	300 2.07	45 1.75	116 4.57	76 2.99	65 2.56	39 1.54	3/8 × 55 M10X57	
50 × 40 2 × 1 1/2	60.3 × 48.3 2.375 × 1.900	300 2.07	45 1.75	116 4.57	76 2.99	65 2.56	39 1.54	3/8 × 55 M10X57	
65 × 15 2 1/2 × 1/2	73.0 × 21.3 2.875 × 0.825	300 2.07	38 1.50	137 5.39	71 2.76	68 2.67	49 1.93	1/2 × 70 M12X70	
65 × 20 2 1/2 × 3/4	73.0 × 26.9 2.875 × 1.050	300 2.07	38 1.50	137 5.39	71 2.76	68 2.67	49 1.93	1/2 × 70 M12X70	
65 × 25 2 1/2 × 1	73.0 × 33.7 2.875 × 1.315	300 2.07	38 1.50	137 5.39	71 2.76	70 2.75	49 1.93	1/2 × 70 M12X70	
65 × 32 2 1/2 × 1 1/4	73.0 × 42.4 2.875 × 1.660	300 2.07	51 2.00	137 5.397	84.5 3.33	73 2.87	49 1.93	1/2 × 70 M12X70	
65 × 40 2 1/2 × 1 1/2	73.0 × 48.3 2.875 × 1.900	300 2.07	51 2.00	137 5.39	84.5 3.33	73 2.87	49 1.93	1/2 × 70 M12X70	
65 × 15 76.1 × 1 1/2	76.1 × 21.3 3.000 × 0.825	300 2.07	38 1.50	137 5.39	71 2.80	61.5 2.42	49.5 1.95	1/2 × 70 M12X70	
65 × 20 76.1 × 3/4	76.1 × 26.9 3.000 × 1.050	300 2.07	38 1.50	137 5.39	71 2.80	68 2.67	49.5 1.95	1/2 × 70 M12X70	
65 × 25 76.1 × 1	76.1 × 33.7 3.000 × 1.315	300 2.07	38 1.50	137 5.39	71 2.80	75 3.05	49.5 1.95	1/2 × 70 M12X70	
65 × 32 76.1 × 1 1/4	76.1 × 42.4 3.000 × 1.660	300 2.07	51 2.00	137 5.39	84.5 3.33	75 3.05	49.5 1.95	1/2 × 70 M12X70	
65 × 40 76.1 × 1 1/2	76.1 × 48.3 3.000 × 1.900	300 2.07	51 2.00	137 5.39	84.5 3.33	75 3.05	49.5 1.95	1/2 × 70 M12X70	
80 × 15 3 × 1/2	88.9 × 21.3 3.500 × 0.825	300 2.07	38 1.50	152 5.98	72.5 2.85	71.5 2.81	56.5 2.22	1/2 × 75 M12X76	
80 × 20 3 × 3/4	88.9 × 26.9 3.500 × 1.050	300 2.07	38 1.50	152 5.98	72.5 2.85	71.5 2.81	56.5 2.22	1/2 × 75 M12X76	
80 × 25 3 × 1	88.9 × 33.7 3.500 × 1.315	300 2.07	38 1.50	152 5.98	72.5 2.85	80 3.15	56.5 2.22	1/2 × 75 M12X76	
80 × 32 3 × 1 1/4	88.9 × 42.4 3.500 × 1.660	300 2.07	51 2.00	152 5.98	85.5 3.37	80 3.15	56.5 2.22	1/2 × 75 M12X76	
80 × 40 3 × 1 1/2	88.9 × 48.3 3.500 × 1.900	300 2.07	51 2.00	152 5.98	85.5 3.37	80 3.15	56.5 2.22	1/2 × 75 M12X76	
80 × 50 3 × 2	88.9 × 60.3 3.500 × 2.375	300 2.07	64 2.50	152 5.98	98 3.86	80 3.15	56.5 2.22	1/2 × 75 M12X76	

3J

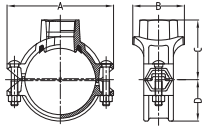
Mechanical Tee
Threaded Outlet

Nominal Size mm/in	Pipe O.D mm/in	Working Pressure PSI/MPa	Hole Dia mm/in +1.6, 0/+0.063, 0	Dimensions				Bolt Size mm/in	Certificate
				A mm/in	B mm/in	C mm/in	D mm/in		
100×15 108.0×1/2	108.1×21.3 4.250×0.825	300 2.07	38 1.50	172 6.77	78.5 3.09	87 3.43	64.5 2.54	1/2×75 M12X76	UL FM
100×20 108.0×3/4	108.1×26.9 4.250×1.050	300 2.07	38 1.50	172 6.77	78.5 3.09	87 3.43	64.5 2.54	1/2×75 M12X76	UL FM
100×25 108.0×1	108.1×33.7 4.250×1.315	300 2.07	38 1.50	172 6.77	78.5 3.09	87 3.43	64.5 2.54	1/2×75 M12X76	UL FM
100×32 108.0×1 1/4	108.1×42.4 4.250×1.660	300 2.07	51 2.00	172 6.77	89 3.50	87 3.43	64.5 2.54	1/2×75 M12X76	UL FM
100×40 108.0×1 1/2	108.0×48.3 4.250×1.900	300 2.07	51 2.00	172 6.77	89 3.50	87 3.43	64.5 2.54	1/2×75 M12X76	UL FM
100×50 108.0×2	108.0×60.3 4.250×2.375	300 2.07	64 2.50	172 6.77	106.5 4.19	92 3.62	64.5 2.54	1/2×75 M12X76	UL FM
100×65 108.0×2 1/2	108.0×76.1 4.250×3.000	300 2.07	70 2.75	172 6.77	106.5 4.19	100 3.94	64.5 2.54	1/2×75 M12X76	UL FM
100×15 4×1/2	114.3×21.3 4.500×0.825	300 2.07	38 1.50	188 7.40	78.5 3.09	90 3.54	70 2.76	1/2×75 M12X76	UL FM Vds
100×20 4×3/4	114.3×26.9 4.500×1.050	300 2.07	38 1.50	188 7.40	78.5 3.09	90 3.54	70 2.76	1/2×75 M12X76	UL FM Vds
100×25 4×1	114.3×33.7 4.500×1.315	300 2.07	38 1.50	188 7.40	78.5 3.09	93 3.66	70 2.76	1/2×75 M12X76	UL FM Vds
100×32 4×1 1/4	114.3×42.4 4.500×1.660	300 2.07	51 2.00	188 7.40	89 3.50	95 3.74	70 2.76	1/2×75 M12X76	UL FM Vds
100×40 4×1 1/2	114.3×48.3 4.500×1.900	300 2.07	51 2.00	188 7.40	89 3.50	97 3.82	70 2.76	1/2×75 M12X76	UL FM Vds
100×50 4×2	114.3×60.3 4.500×2.375	300 2.07	64 2.50	188 7.40	104.5 4.11	100 3.94	70 2.76	1/2×75 M12X76	UL FM Vds
100×65 4×2 1/2	114.3×73.0 4.500×2.875	300 2.07	70 2.75	188 7.40	104.5 4.11	102 4.02	70 2.76	1/2×7 M12X765	UL FM
100×65 4×76.1	114.3×76.1 4.500×3.000	300 2.07	70 2.75	188 7.40	104.5 4.11	102 4.02	70 2.76	1/2×75 M12X76	UL FM Vds LPCB
100×80 4×3	114.3×88.9 4.500×3.500	300 2.07	89 3.50	188 7.40	128 5.039	102 4.02	70 2.76	1/2×75 M12X76	UL FM Vds LPCB
125×32 133.0×1.25	133.0×42.4 5.250×1.660	300 2.07	51 2.00	209 8.23	93 3.66	105 4.13	77 3.03	5/8×85 M16X85	UL FM
125×40 133.0×1 1/2	133.0×48.3 5.250×1.900	300 2.07	51 2.00	209 8.23	93 3.66	105 4.13	77 3.03	5/8×85 M16X85	UL FM
125×50 133.0×2	133.0×60.3 5.250×2.375	300 2.07	64 2.50	209 8.23	112.5 4.43	110 4.33	77 3.03	5/8×85 M16X85	UL FM
125×15 139.7×1/2	139.7×21.3 5.500×0.825	300 2.07	38 1.50	221.5 8.72	78 3.07	110 4.33	84 3.31	5/8×85 M16X85	UL FM Vds
125×20 139.7×3/4	139.7×26.9 5.500×1.050	300 2.07	38 1.50	221.5 8.72	78 3.07	110 4.33	84 3.31	5/8×85 M16X85	UL FM Vds
125×25 139.7×1	139.7×33.7 5.500×1.315	300 2.07	38 1.50	221.5 8.72	78 3.07	110 4.33	84 3.31	5/8×85 M16X85	UL FM Vds
125×32 139.7×1 1/4	139.7×42.4 5.500×1.660	300 2.07	51 2.00	221.5 8.72	95 3.74	112 4.41	84 3.31	5/8×85 M16X85	UL FM Vds
125×40 139.7×1 1/2	139.7×48.3 5.500×1.900	300 2.07	51 2.00	221.5 8.72	95 3.74	112 4.41	84 3.31	5/8×85 M16X85	UL FM Vds
125×50 139.7×2	139.7×60.3 5.500×2.375	300 2.07	64 2.50	221.5 8.72	112.5 4.43	115 4.53	84 3.31	5/8×85 M16X85	UL FM Vds
125×65 139.7×2 1/2	139.7×76.1 5.500×3.000	300 2.07	70 2.75	221.5 8.72	112.5 4.43	115 4.53	84 3.31	5/8×85 M16X85	UL FM Vds LPCB
125×80 139.7×3	139.7×88.9 5.500×3.500	300 2.07	89 3.50	221.5 8.72	132 5.20	120 4.72	84 3.31	5/8×85 M16X85	UL FM Vds LPCB
125×100 139.7×4	139.7×114.3 5.500×4.500	300 2.07	114 4.50	221.5 8.72	156 6.30	125 4.92	84 3.31	5/8×85 M16X85	UL FM Vds LPCB
150×15 159.0×1/2	159.0×21.3 6.250×0.825	300 2.07	38 1.50	244 9.60	78 3.07	116 4.57	94 3.70	5/8×105 M16X108	UL FM
150×25 159.0×1	159.0×33.7 6.250×1.315	300 2.07	38 1.50	244 9.60	78 3.07	116 4.57	94 3.70	5/8×105 M16X108	UL FM
150×32 159.0×1 1/4	159.0×42.4 6.250×1.660	300 2.07	51 2.00	244 9.60	93 3.66	118 4.65	94 3.70	5/8×105 M16X108	UL FM
150×40 159.0×1 1/2	159.0×48.3 6.250×1.900	300 2.07	51 2.00	244 9.60	93 3.66	118 4.65	94 3.70	5/8×105 M16X108	UL FM

3J

Mechanical Tee Threaded Outlet

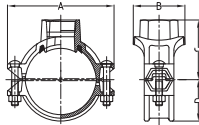

Nominal Size mm/in	Pipe O.D mm/in	Working Pressure PSI/MPa	Hole Dia mm/in +1.6, 0/+0.063, 0	Dimensions				Bolt Size mm/in	Certificate
				A mm/in	B mm/in	C mm/in	D mm/in		
150×50 159.0×2	159.0×60.3 6.250×2.375	300 2.07	64 2.50	244 9.60	112.5 4.43	125 4.92	94 3.70	5/8×105 M16×108	UL FM
150×65 159.0×76.1	159.0×76.1 6.250×3.000	300 2.07	70 2.75	244 9.60	112.5 4.43	125 4.92	94 3.70	5/8×105 M16×108	UL FM
150×80 159.0×3	159.0×88.9 6.250×3.500	300 2.07	89 3.50	244 9.60	133 5.20	125 4.92	94 3.70	5/8×105 M16×108	UL FM
150×100 159.0×4	159.1×114.3 6.250×4.500	175 1.20	114 4.50	244 9.60	156.5 6.16	130 5.12	94 3.70	5/8×105 M16×108	UL FM
150×15 165.1×1/2	165.1×21.3 6.500×0.825	300 2.07	38 1.50	244 9.60	78 3.07	110 4.33	97.5 3.84	5/8×105 M16×108	UL FM
125×20 165.1×3/4	165.1×26.9 6.500×1.050	300 2.07	38 1.50	244 9.60	78 3.07	110 4.33	97.5 3.84	5/8×105 M16×108	UL FM
150×25 165.1×1	165.1×33.7 6.500×1.315	300 2.07	38 1.50	244 9.60	78 3.07	118 4.65	97.5 3.84	5/8×105 M16×108	UL FM
150×32 165.1×1 1/4	165.1×42.4 6.500×1.660	300 2.07	51 2.00	244 9.60	93 3.66	118 4.65	97.5 3.84	5/8×105 M16×108	UL FM
150×40 165.1×1 1/2	165.1×48.3 6.500×1.900	300 2.07	51 2.00	244 9.60	93 3.66	118 4.65	97.5 3.84	5/8×105 M16×108	UL FM
150×50 165.1×2	165.1×60.3 6.500×2.375	300 2.07	64 2.50	244 9.60	112.5 4.43	128.5 5.43	97.5 3.84	5/8×105 M16×108	UL FM
150×65 165.1×3	165.1×76.1 6.500×3.000	300 2.07	70 2.75	244 9.60	112.5 4.43	128.5 5.43	97.5 3.84	5/8×105 M16×108	UL FM LPCB
150×80 165.1×3	165.1×88.9 6.500×3.500	300 2.07	89 3.50	244 9.60	132 5.20	128.5 5.06	97.5 3.84	5/8×105 M16×108	UL FM LPCB
150×100 165.1×4	165.1×114.3 6.500×4.500	225 1.6	114 4.50	244 9.60	154 6.18	135 5.32	97.5 3.84	5/8×105 M16×108	UL FM LPCB
150×32 6×1 1/4	168.3×42.4 6.500×1.660	300 2.07	51 2.00	247 9.72	95 3.74	122 4.80	98.5 3.88	5/8×105 M16×108	UL FM VdS
150×40 6×1 1/2	168.3×48.3 6.500×1.900	300 2.07	51 2.00	247 9.72	95 3.74	122 4.80	98.5 3.88	5/8×105 M16×108	UL FM VdS
150×50 6×2	168.3×60.3 6.625×2.375	300 2.07	64 2.50	247 9.72	112.5 4.43	132 5.20	98.5 3.88	5/8×105 M16×108	UL FM VdS
150×65 6×2 1/2	168.3×73.0 6.625×2.875	300 2.07	70 2.75	247 9.72	112.5 4.43	132 5.20	98.5 3.88	5/8×105 M16×108	UL FM
150×65 6×3	168.3×76.1 6.625×3.000	300 2.07	70 2.75	247 9.72	112.5 4.43	132 5.20	98.5 3.88	5/8×105 M16×108	UL FM VdS LPCB
150×80 6×3	168.3×88.9 6.625×3.500	300 2.07	89 3.50	247 9.72	132 5.20	140 5.51	98.5 3.88	5/8×105 M16×108	UL FM VdS LPCB
150×100 6×4	168.3×114.3 6.625×4.500	300 2.07	114 4.50	247 9.72	160 6.30	140 5.51	98.5 3.88	5/8×105 M16×108	UL FM VdS LPCB
200×25 8×1	219.1×33.7 8.625×1.315	300 2.07	38 1.50	320 12.60	79.5 3.13	150 5.91	125 4.92	3/4×115 M20×115	UL FM VdS
200×32 8×1 1/4	219.1×42.4 8.625×1.660	300 2.07	51 2.00	320 12.60	96.5 3.80	150 5.91	125 4.92	3/4×115 M20×115	UL FM VdS
200×40 8×1 1/2	219.1×48.3 8.625×1.900	300 2.07	51 2.00	320 12.60	96.5 3.80	150 5.91	125 4.92	3/4×115 M20×115	UL FM VdS
200×50 8×2	219.1×60.3 8.625×2.375	300 2.07	64 2.50	320 12.60	117 4.61	160 6.30	125 4.92	3/4×115 M20×115	UL FM VdS
200×65 8×2 1/2	219.1×73.0 8.625×2.875	300 2.07	70 2.75	320 12.60	118 4.65	160 6.30	125 4.92	3/4×115 M20×115	UL FM
200×65 8×3	219.1×76.1 8.625×3.000	300 2.07	70 2.75	320 12.60	118 4.65	160 6.30	125 4.92	3/4×115 M20×115	UL FM VdS LPCB
200×80 8×3	219.1×88.9 8.625×3.500	300 2.07	89 3.50	320 12.60	136.5 5.37	160 6.30	125 4.92	3/4×115 M20×115	UL FM VdS LPCB
200×100 8×4	219.1×114.3 8.625×4.500	300 2.07	114 4.50	320 12.60	164 6.46	160 6.30	125 4.92	3/4×115 M20×115	UL FM VdS LPCB
250×40 10×1 1/2	273.0×48.3 10.750×1.900	300 2.07	51 2.00	376 14.80	95.5 3.76	180 7.09	155 6.10	3/4×120 M20×115	UL FM
250×50 10×2	273.0×60.3 10.750×2.375	300 2.07	64 2.50	376 14.80	118 4.65	185 7.28	155 6.10	3/4×120 M20×115	UL FM VdS
250×65 10×2 1/2	273.0×76.1 10.750×3.000	300 2.07	70 2.75	376 14.80	118 4.65	190 7.48	155 6.10	3/4×120 M20×115	UL FM VdS
250×80 10×3	273.0×88.9 10.750×3.500	300 2.07	89 3.50	376 14.80	136.5 5.37	190 7.48	155 6.10	3/4×120 M20×115	UL FM VdS
250×100 10×4	273.0×114.3 10.750×4.500	300 2.07	114 4.50	376 14.80	164 6.46	190 7.48	155 6.10	3/4×120 M20×115	UL FM VdS