

3G

Mechanical Tee Grooved Outlet

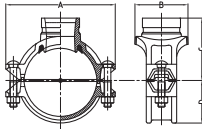

Nominal Size mm/in	Pipe O.D. mm/in	Working Pressure PSI/MPa	Hole Dia mm/in +1.6, 0/+0.063, 0	Dimensions				Bolt Size mm/in	Certificate
				A mm/in	B mm/in	C mm/in	D mm/in		
50 × 32 2 × 1 1/4	60.3 × 42.4 2.375 × 1.660	300 2.07	45 1.75	116 4.57	76 2.99	69.5 2.74	39 1.54	3/8 × 55 M10X57	UL FM Vds
50 × 40 2 × 1 1/2	60.3 × 48.3 2.375 × 1.900	300 2.07	47.5 1.75	116 4.57	76 2.99	69.5 2.74	39 1.54	3/8 × 55 M10X57	UL FM Vds
65 × 25 2 1/2 × 1	73.0 × 33.7 2.875 × 1.315	300 2.07	38 1.50	137 5.39	84.5 2.80	78 3.07	49 1.93	1/2 × 70 M12X70	—
65 × 32 2 1/2 × 1 1/4	73.0 × 42.4 2.875 × 1.660	300 2.07	51 2.00	137 5.39	84.5 3.33	78 3.07	49 1.93	1/2 × 70 M12X70	UL FM
65 × 40 2 1/2 × 1 1/2	73.0 × 48.3 2.875 × 1.900	300 2.07	50 2.00	137 5.39	84.5 3.33	78 3.07	49 1.93	1/2 × 70 M12X70	UL FM
65 × 25 2 1/2 × 1	76.1 × 33.7 3.000 × 1.315	300 2.07	38 1.50	137 5.39	84.5 2.80	78 3.07	49.5 1.95	1/2 × 70 M12X70	UL FM Vds
65 × 32 2 1/2 × 1 1/4	76.1 × 42.4 3.000 × 1.660	300 2.07	51 2.00	137 5.39	84.5 3.33	78 3.07	49.5 1.95	1/2 × 70 M12X70	UL FM Vds
65 × 40 2 1/2 × 1 1/2	76.1 × 48.3 3.000 × 1.900	300 2.07	50 2.00	137 5.39	84.5 3.33	78 3.07	49.5 1.95	1/2 × 70 M12X70	UL FM Vds
80 × 25 3 × 1	88.9 × 33.7 3.500 × 1.315	300 2.07	38 1.50	152 5.98	72.5 2.85	84.5 3.33	56.5 2.22	1/2 × 75 M12X76	UL FM Vds
80 × 32 3 × 1 1/4	88.9 × 42.4 3.500 × 1.660	300 2.07	51 2.00	152 5.98	85.5 3.37	84.5 3.33	56.5 2.22	1/2 × 75 M12X76	UL FM Vds
80 × 40 3 × 1 1/2	88.9 × 48.3 3.500 × 1.900	300 2.07	50 2.00	152 5.98	85.5 3.37	84.5 3.33	56.5 2.22	1/2 × 75 M12X76	UL FM Vds
80 × 50 3 × 2	88.9 × 60.3 3.500 × 2.375	300 2.07	64 2.50	152 5.98	98 3.86	84.5 3.33	56.5 2.22	1/2 × 75 M12X76	UL FM Vds
100 × 25 4 × 1	114.3 × 33.7 4.500 × 1.315	300 2.07	38 1.50	188 7.40	108 3.09	102 4.02	70 2.76	1/2 × 75 M12X76	UL FM Vds
100 × 32 4 × 1 1/4	114.3 × 42.4 4.500 × 1.660	300 2.07	51 2.00	188 7.40	108 3.50	102 4.02	70 2.76	1/2 × 75 M12X76	UL FM Vds
100 × 40 4 × 1 1/2	114.3 × 48.3 4.500 × 1.900	300 2.07	50 2.00	188 7.40	89 3.50	102 4.02	70 2.76	1/2 × 75 M12X76	UL FM Vds
100 × 50 4 × 2	114.3 × 60.3 4.500 × 2.375	300 2.07	64 2.5	188 7.40	104.5 4.11	102 4.02	70 2.76	1/2 × 75 M12X76	UL FM Vds
100 × 65 4 × 2 1/2	114.3 × 73.0 4.500 × 2.875	300 2.07	75 2.75	188 7.40	104.5 4.11	102 4.02	70 2.76	1/2 × 75 M12X76	UL FM
100 × 65 4 × 2 1/2	114.3 × 76.1 4.500 × 3.000	300 2.07	70 2.75	188 7.40	104.5 4.11	102 4.02	70 2.76	1/2 × 75 M12X76	Vds LPCB
100 × 80 4 × 3	114.3 × 88.9 4.500 × 3.500	300 2.07	89 3.50	188 7.40	128 5.03	102 4.02	70 2.76	1/2 × 75 M12X76	UL FM Vds LPCB
125 × 32 139.7 × 1 1/4	139.7 × 42.4 5.500 × 1.660	300 2.07	51 2.00	221.5 8.72	95 3.74	118 4.65	84 3.31	5/8 × 85 M16X85	UL FM
125 × 40 139.7 × 1 1/2	139.7 × 48.3 5.500 × 1.900	300 2.07	50 2.00	221.5 8.72	95 3.74	118 4.65	84 3.31	5/8 × 85 M16X85	UL FM
125 × 50 139.7 × 2	139.7 × 60.3 5.500 × 2.375	300 2.07	64 2.5	221.5 8.72	112.5 4.43	118 4.65	84 3.31	5/8 × 85 M16X85	UL FM Vds
125 × 65 139.7 × 2 1/2	139.7 × 76.1 5.500 × 3.000	300 2.07	75 2.75	221.5 8.72	112.5 4.43	118 4.65	84 3.31	5/8 × 85 M16X85	UL FM Vds LPCB
125 × 80 139.7 × 3	139.7 × 88.9 5.500 × 3.500	300 2.07	89 3.50	221.5 8.720	132 5.20	118 4.65	84 3.31	5/8 × 85 M16X85	UL FM Vds LPCB
125 × 100 139.7 × 4	139.7 × 114.3 5.500 × 4.500	300 2.07	114 4.50	221.5 8.720	160 6.30	125 4.92	84 3.31	5/8 × 85 M16X85	UL FM Vds LPCB
150 × 50 159.0 × 2	159.1 × 60.3 6.250 × 2.375	300 2.07	64 2.5	244 9.60	112.5 4.43	125 4.92	94 3.70	5/8 × 105 M16X108	—
150 × 100 159.0 × 108.0	159.1 × 108.0 6.250 × 4.250	300 2.07	114 4.50	244 9.60	154 6.06	133 5.24	94 3.70	5/8 × 105 M16X108	UL FM
150 × 100 159.0 × 4	159.1 × 114.3 6.250 × 4.500	300 2.07	114 4.50	244 9.60	159 6.26	125 4.92	94 3.70	5/8 × 105 M16X108	UL FM
150 × 50 165.1 × 2	165.1 × 60.3 6.500 × 2.375	300 2.07	64 2.5	244 9.60	112.5 4.43	127 5.00	97.5 3.84	5/8 × 105 M16X108	UL FM
150 × 65 165.1 × 2 1/2	165.1 × 76.1 6.500 × 3.000	300 2.07	75 2.75	244 9.60	112.5 4.43	130 5.12	97.5 3.84	5/8 × 105 M16X108	UL FM LPCB
150 × 80 165.0 × 3	165.1 × 88.9 6.500 × 3.500	300 2.07	89 3.50	244 9.60	132 5.20	130 5.12	97.5 3.84	5/8 × 105 M16X108	UL FM LPCB
150 × 100 165.0 × 4	165.1 × 114.3 6.500 × 4.500	300 2.07	114 4.50	244 9.60	154 6.06	135 5.32	97.5 3.84	5/8 × 105 M16X108	UL FM LPCB
150 × 50 6 × 1 1/2	168.3 × 48.3 6.500 × 1.900	300 2.07	50 2.00	247 9.72	95 3.74	128 5.04	96.5 3.88	5/8 × 105 M16X108	UL FM Vds
150 × 50 6 × 2	168.3 × 60.3 6.625 × 2.375	300 2.07	64 2.5	247 9.72	114 4.49	134 5.28	96.5 3.88	5/8 × 105 M16X108	UL FM Vds

3G

Mechanical Tee Grooved Outlet

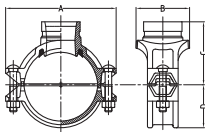

Nominal Size mm/in	Pipe O.D mm/in	Working Pressure PSI/MPa	Hole Dia mm/in +1.6,0/+0.063,0	Dimensions				Bolt Size mm/in	Certificate
				A mm/in	B mm/in	C mm/in	D mm/in		
150×65 6×2½	168.3×73.0 6.625×2.875	300 2.07	70 2.75	247 9.72	112.5 4.43	135 5.32	98.5 3.88	5/8×105 M16X108	UL FM
150×65 6×2½	168.3×76.1 6.625×3.000	300 2.07	70 2.75	247 9.72	112.5 4.43	135 5.32	98.5 3.88	5/8×105 M16X108	VdS LPCB
150×80 6×3	168.3×88.9 6.625×3.500	300 2.07	89 3.50	247 9.72	132 5.20	136.5 5.37	98.5 3.88	5/8×105 M16X108	UL FM VdS LPCB
150×100 6×4	168.3×114.3 6.625×4.500	300 2.07	114 4.50	247 9.72	160 6.30	138 5.43	98.5 3.88	5/8×105 M16X108	UL FM VdS LPCB
200×50 8×2	219.1×60.3 8.625×2.375	300 2.07	64 2.5	320 12.60	118 4.65	158 6.22	125 4.92	3/4×115 M20X115	UL FM VdS
200×65 8×2½	216.3×76.1 8.516×3.000	300 2.07	70 2.75	315 12.40	117 4.61	157 6.18	122 4.80	3/4×115 M20X115	—
200×65 8×2½	219.1×73.0 8.625×2.875	300 2.07	70 2.75	320 12.60	118 4.65	158 6.22	125 4.92	3/4×115 M20X115	UL FM VdS LPCB
200×65 8×2½	219.1×76.1 8.625×3.000	300 2.07	70 2.75	320 12.60	118 4.65	158 6.22	125 4.92	3/4×115 M20X115	UL FM VdS LPCB
200×80 8×3	219.1×88.9 8.625×3.500	300 2.07	89 3.50	320 12.60	136.5 5.37	161 6.34	125 4.92	3/4×115 M20X115	UL FM VdS LPCB
200×100 8×4	219.1×108.0 8.625×4.250	300 2.07	114 4.50	320 12.60	162 6.38	161 6.34	125 4.92	3/4×115 M20X115	UL FM
200×100 8×4	219.1×114.3 8.625×4.500	300 2.07	114 4.50	320 12.60	162 6.38	161 6.34	125 4.92	3/4×115 M20X115	UL FM VdS LPCB
250×65 10×2½	273.0×76.1 10.75×3.000	300 2.07	70 2.75	376 14.80	118 4.65	189 7.44	155 6.10	3/4×120 M20X115	—
250×80 10×3	273.0×88.9 10.75×3.500	300 2.07	89 3.50	376 14.80	136.5 5.37	189 7.44	155 6.10	3/4×120 M20X115	—
250×100 10×4	273.0×108 10.75×4.250	300 2.07	114 4.50	376 14.80	164 6.46	189 7.44	155 6.10	3/4×120 M20X115	UL FM
250×100 10×4	273.0×114.3 10.75×4.500	300 2.07	114 4.50	376 14.80	164 6.46	189 7.44	155 6.10	3/4×120 M20X115	UL FM VdS