



TAPÓN HEMBRA (CAP)

Normas de Diseño :
ANSI / ASME B16.9

Material:

Acero A234 WPB

Cédula:

STD, SCH 40, XS, SCH 80,

SCH 160

Espesor Mínimo:

-12.5% del valor nominal

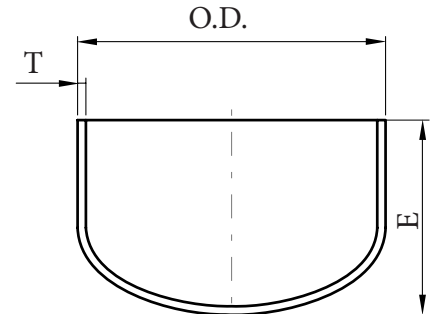

Unidad: Milímetros (mm)

MEDIDA	DIÁMETRO EXTERIOR (OD)	ESPESOR DE PARED (T)					LARGO (E)	LÍMITE DE LARGO CON ESPESOR DE PARED (E)	PESO APROX (Kg)				
		STD	SCH 40	XS	SCH 80	SCH 160			STD	SCH 40	XS	SCH 80	SCH 160
1/2"	21.3	2.8	2.8	3.7	3.7	4.8	25.4	3.73	0.04	0.04	0.05	0.05	-
3/4"	26.7	2.9	2.9	3.9	3.9	5.6	25.4	3.91	0.05	0.05	0.07	0.07	-
1"	33.5	3.4	3.4	4.5	4.5	6.4	38.1	4.55	0.11	0.11	0.15	0.15	-
1 1/4"	42.2	3.6	3.6	4.9	4.9	6.4	38.1	4.85	0.14	0.14	0.20	0.20	-
1 1/2"	48.3	3.7	3.7	3.7	3.7	7.1	38.1	5.08	0.17	0.17	0.24	0.24	0.35
2"	60.5	3.9	3.9	5.5	5.5	8.7	38.1	5.54	0.24	0.24	0.33	0.33	0.54
2 1/2"	73.2	5.2	5.2	7.0	7.0	9.5	38.1	7.01	0.42	0.42	0.57	0.57	0.77
3"	88.9	5.5	5.5	7.6	7.6	11.1	50.8	7.62	0.67	0.67	0.92	0.92	1.40
4"	114.3	6.0	6.0	8.6	8.6	13.5	63.5	8.56	1.17	1.17	1.68	1.68	2.76
5"	141.2	6.6	6.6	9.5	9.5	15.9	76.2	9.53	1.90	1.90	2.73	2.73	4.85
6"	168.1	7.1	7.1	11.0	11.0	18.3	88.9	10.97	2.83	2.83	4.38	4.38	7.81
8"	218.9	8.2	8.2	12.7	12.7	23.0	101.6	12.70	5.11	5.11	7.91	7.91	11.52
10"	273.1	9.3	9.3	12.7	15.0	28.6	127.0	12.70	8.92	8.92	11.3	16.4	28.9
12"	323.9	9.52	10.3	12.7	17.5	33.3	152.4	12.70	12	13.1	16	26.4	47.7
14"	355.9	9.52	11.1	12.7	19.1	35.7	165.1	12.70	15	18.6	20	34.9	61.2
16"	406.4	9.52	12.7	12.7	21.4	40.4	177.8	12.70	19	26.7	25	49.0	130
18"	457.2	9.52	14.3	12.7	23.8	45.2	203.2	12.70	25	41.5	33	69.0	131
20"	508.0	9.52	15.0	12.7	26.1	50.0	228.6	12.70	31	54.1	41	93.7	179
22"	558.8	9.52	-	12.7	28.6	54.0	254.0	12.70	39	-	50	116	219
24"	609.6	9.52	17.5	12.7	31.0	59.5	266.7	12.70	44	90.1	58	160	307

* Fotos y medidas referenciales, sujetas a cambios sin previo aviso por parte del proveedor o fabricante.