



TEE

Normas de Diseño :
ANSI / ASME B16.9

Material:

Acero A234 WPB

Cédula:

STD, SCH 40, XS, SCH 80,
SCH 160

Espesor Mínimo:

-12.5% del valor nominal

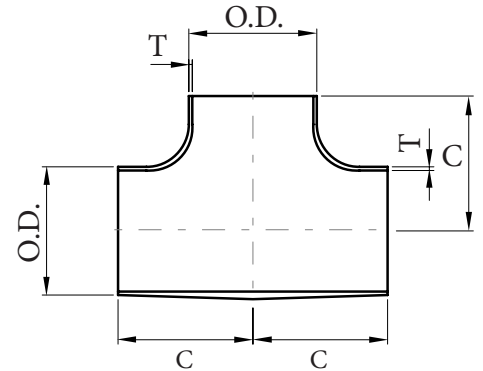

Unidad: Milímetros (mm)

MEDIDA	DIÁ- METRO EXTERIOR (OD)	ESPESOR DE PARED (T)					CEN- TRO A FINAL (C)	PESO APROX (Kg)				
		STD	SCH 40	XS	SCH 80	SCH 160		STD	SCH 40	XS	SCH 80	SCH 160
1/2"	21.3	2.8	2.8	3.7	3.7	4.8	25.4	0.09	0.09	0.11	0.11	-
3/4"	26.7	2.9	2.9	3.9	3.9	5.6	28.4	0.13	0.13	0.17	0.17	-
1"	33.5	3.4	3.4	4.5	4.5	6.4	38.1	0.25	0.25	0.32	0.32	-
1 1/4"	42.2	3.6	3.6	4.9	4.9	6.4	47.8	0.43	0.43	0.56	0.56	-
1 1/2"	48.3	3.7	3.7	3.7	3.7	7.1	57.2	0.61	0.61	0.81	0.81	-
2"	60.5	3.9	3.9	5.5	5.5	8.7	63.5	0.88	0.88	1.20	1.20	-
2 1/2"	73.2	5.2	5.2	7.0	7.0	9.5	76.2	1.74	1.74	2.28	2.28	3.63
3"	88.9	5.5	5.5	7.6	7.6	11.1	85.9	2.41	2.41	3.25	3.25	5.87
4"	114.3	6.0	6.0	8.6	8.6	13.5	104.6	4.12	4.12	5.77	5.77	9.76
5"	141.2	6.6	6.6	9.5	9.5	15.9	124.0	6.54	6.54	9.20	9.20	22.2
6"	168.1	7.1	7.1	11.0	11.0	18.3	142.7	9.58	9.58	14.5	14.5	31.4
8"	218.9	8.2	8.2	12.7	12.7	23.0	177.8	17.9	17.9	27.1	27.1	50.7
10"	273.1	9.3	9.3	12.7	15.0	28.6	215.9	41.0	41.0	58.40	60.8	96.7
12"	323.9	9.5	10.3	12.7	17.5	33.3	254.0	65.0	70.5	78.0	95.8	155
14"	355.9	9.5	11.1	12.7	19.1	35.7	279.4	85.0	105.0	108.9	129	201
16"	406.4	9.5	12.7	12.7	21.4	40.4	304.8	110	129.80	138.50	173	334
18"	457.2	9.5	14.3	12.7	23.8	45.2	342.9	105	156	130.8	253	470
20"	508.0	9.5	15.0	12.7	26.1	50.0	381.0	130.4	204	159.7	353	631
22"	558.8	9.5	-	12.7	28.6	54.0	419.1	158.2	-	196.6	453	835
24"	609.6	9.5	17.5	12.7	31.0	59.5	431.8	175.3	299	218.0	548	1012