



\* Reference photo

**Material:** ASTM A403 304L  
**Design:** ASME / ANSI B16.9  
**Ends:** Butt Welded  
**Schedule:** SCH 10S

### TENSILE REQUIREMENTS

MATERIAL	Yield Strength, min, ksi [MPa]	Tensile Strength, min, ksi [MPa]
304L	25 [170]	70 [485]

### DIMENSIONS

Nominal Pipe Size (NPS)	Outside Diameter at Bevel, mm (in.)	Center-to-End, B, mm (in.)	Nominal Wall Thickness, mm (in.)	Approx. Weight, kg
1/2	21.3 (0.84)	16 (0.62)	2.11 (0.083)	0.039
3/4	26.7 (1.05)	19 (0.75)	2.11 (0.083)	0.064
1	33.4 (1.32)	22 (0.88)	2.77 (0.109)	0.103
1 1/4	42.2 (1.66)	25 (1.00)	2.77 (0.109)	0.142
1 1/2	48.3 (1.90)	29 (1.12)	2.77 (0.109)	0.571
2	60.3 (2.38)	35 (1.38)	2.77 (0.109)	0.406
2 1/2	73.0 (2.88)	44 (1.75)	3.05 (0.12)	0.571
3	88.9 (3.50)	51 (2.00)	3.05 (0.12)	0.764
3 1/2	101.6 (4.00)	57 (2.25)	3.05 (0.12)	0.985
4	114.3 (4.50)	64 (2.50)	3.05 (0.12)	1.71
5	141.3 (5.56)	79 (3.12)	3.4 (0.134)	2.43
6	168.3 (6.62)	95 (3.75)	3.4 (0.134)	4.9
8	219.1 (8.62)	127 (5.00)	3.76 (0.148)	7.8
10	273.0 (10.75)	159 (6.25)	4.19 (0.165)	13
12	323.8 (12.75)	190 (7.50)	4.57 (0.18)	18.14
14	355.6 (14.00)	222 (8.75)	4.78 (0.188)	-
16	406.4 (16.00)	254 (10.00)	4.78 (0.188)	-
18	457.0 (18.00)	286 (11.25)	4.78 (0.188)	-
20	508.0 (20.00)	318 (12.50)	5.54 (0.218)	-
22	559.0 (22.00)	343 (13.50)	5.54 (0.218)	-
24	610.0 (24.00)	381 (15.00)	6.35 (0.25)	-

\* Conversion equivalents are approximate. Reference weights.

### PERMITTED VARIATIONS IN WALL THICKNESS

NPS Designator	Tolerance, % from Nominal	
	Over	Under
1/8 to 2 1/2 incl., all t/D ratios	20.0	12.5
3 to 18 incl., t/D up to 5 % incl.	22.5	12.5
3 to 18 incl., t/D > 5%	15.0	12.5

where:

t = Nominal Wall Thickness

D = Ordered Outside Diameter

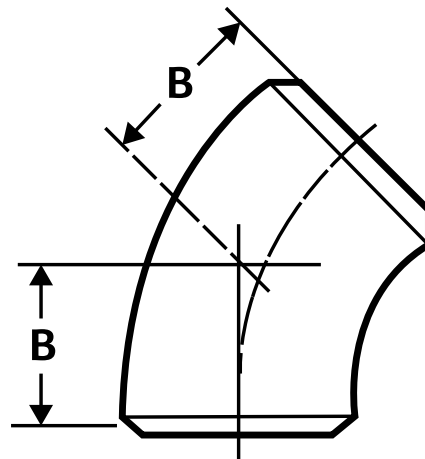

Fiorella Representaciones S.A.C.  
 Importador y distribuidor autorizado de productos HGA  
 para Perú y para su exportación.

\* Photos and reference data. Reference weights. We accept no liability for incorrect uses or misinterpretations of this data.

