



\* Reference photo

**Material:** ASTM A403 304L  
**Design:** ASME / ANSI B16.9  
**Ends:** Butt Welded  
**Schedule:** SCH 40S

### TENSILE REQUIREMENTS

| MATERIAL | Yield Strength, min, ksi [MPa] | Tensile Strength, min, ksi [MPa] |
|----------|--------------------------------|----------------------------------|
| 304L     | 25 [170]                       | 70 [485]                         |

### DIMENSIONS

| Nominal Pipe Size (NPS) | Outside Diameter at Bevel, mm (in.) | Center-to-End, mm (in.) |            | Nominal Wall Thickness, mm (in.) | Approx. Weight, kg |
|-------------------------|-------------------------------------|-------------------------|------------|----------------------------------|--------------------|
|                         |                                     | Run, C                  | Outlet, M  |                                  |                    |
| 1/2                     | 21.3 (0.84)                         | 25 (1.00)               | 25 (1.00)  | 2.77(0.109)                      | 0.17               |
| 3/4                     | 26.7 (1.05)                         | 29 (1.12)               | 29 (1.12)  | 2.87(0.113)                      | 0.21               |
| 1                       | 33.4 (1.32)                         | 38 (1.50)               | 38 (1.50)  | 3.38(0.133)                      | 0.35               |
| 1 1/4                   | 42.2 (1.66)                         | 48 (1.88)               | 48 (1.88)  | 3.56(0.14)                       | 0.6                |
| 1 1/2                   | 48.3 (1.90)                         | 57 (2.25)               | 57 (2.25)  | 3.68(0.145)                      | 0.92               |
| 2                       | 60.3 (2.38)                         | 64 (2.50)               | 64 (2.50)  | 3.91(0.154)                      | 1.6                |
| 2 1/2                   | 73.0 (2.88)                         | 76 (3.00)               | 76 (3.00)  | 5.16(0.203)                      | 3.19               |
| 3                       | 88.9 (3.50)                         | 86 (3.38)               | 86 (3.38)  | 5.49(0.216)                      | 3.3                |
| 3 1/2                   | 101.6 (4.00)                        | 95 (3.75)               | 95 (3.75)  | 5.74(0.226)                      | -                  |
| 4                       | 114.3 (4.50)                        | 105(4.12)               | 105(4.12)  | 6.02(0.237)                      | 5.46               |
| 5                       | 141.3 (5.56)                        | 124(4.88)               | 124(4.88)  | 6.55(0.258)                      | 9.63               |
| 6                       | 168.3 (6.62)                        | 143(5.62)               | 143(5.62)  | 7.11(0.28)                       | 11.42              |
| 8                       | 219.1 (8.62)                        | 178(7.00)               | 178(7.00)  | 8.18(0.322)                      | 21                 |
| 10                      | 273.0 (10.75)                       | 216(8.50)               | 216(8.50)  | 9.27(0.365)                      | 26.6               |
| 12                      | 323.8 (12.75)                       | 254(10.00)              | 254(10.00) | 9.53(0.375)                      | 39                 |
| 14                      | 355.6 (14.00)                       | 279(11.00)              | 279(11.00) | 9.53(0.375)                      | -                  |
| 16                      | 406.4 (16.00)                       | 305(12.00)              | 305(12.00) | 9.53(0.375)                      | -                  |

### PERMITTED VARIATIONS IN WALL THICKNESS

| NPS Designator                     | Tolerance, % from Nominal |       |
|------------------------------------|---------------------------|-------|
|                                    | Over                      | Under |
| 1/8 to 2 1/2 incl., all t/D ratios | 20.0                      | 12.5  |
| 3 to 18 incl., t/D up to 5 % incl. | 22.5                      | 12.5  |
| 3 to 18 incl., t/D > 5%            | 15.0                      | 12.5  |

where:

t = Nominal Wall Thickness  
D = Ordered Outside Diameter

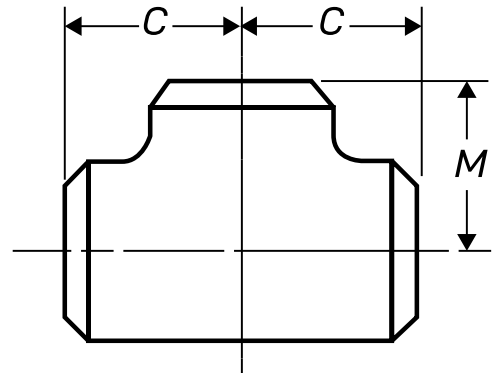

Fiorella Representaciones S.A.C.  
Importador y distribuidor autorizado de productos HGA  
para Perú y para su exportación.

\* Conversion equivalents are approximate. Reference weights.

\* Photos and reference data. Reference weights. We accept no liability for incorrect uses or misinterpretations of this data.

