



\* Reference photo

**Material:** ASTM A403 316L  
**Design:** ASME / ANSI B16.9  
**Ends:** Butt Welded  
**Schedule:** SCH 10S

### TENSILE REQUIREMENTS

MATERIAL	Yield Strength, min, ksi [MPa]	Tensile Strength, min, ksi [MPa]
316L	25 [170]	70 [485]

### DIMENSIONS

Nominal Pipe Size (NPS)	Outside Diameter at Bevel, mm (in.)	Center-to-End, mm (in.)		Nominal Wall Thickness, mm (in.)	Approx. Weight, kg
		Run, C	Outlet, M		
1/2	21.3 (0.84)	25 (1.00)	25 (1.00)	2.11 (0.083)	0.1
3/4	26.7 (1.05)	29 (1.12)	29 (1.12)	2.11 (0.083)	0.14
1	33.4 (1.32)	38 (1.50)	38 (1.50)	2.77 (0.109)	0.28
1 1/4	42.2 (1.66)	48 (1.88)	48 (1.88)	2.77 (0.109)	0.51
1 1/2	48.3 (1.90)	57 (2.25)	57 (2.25)	2.77 (0.109)	0.69
2	60.3 (2.38)	64 (2.50)	64 (2.50)	2.77 (0.109)	0.83
2 1/2	73.0 (2.88)	76 (3.00)	76 (3.00)	3.05 (0.12)	1.37
3	88.9 (3.50)	86 (3.38)	86 (3.38)	3.05 (0.12)	1.78
3 1/2	101.6 (4.00)	95 (3.75)	95 (3.75)	3.05 (0.12)	-
4	114.3 (4.50)	105 (4.12)	105 (4.12)	3.05 (0.12)	3.6
5	141.3 (5.56)	124 (4.88)	124 (4.88)	3.4 (0.134)	5.44
6	168.3 (6.62)	143 (5.62)	143 (5.62)	3.4 (0.134)	7.72
8	219.1 (8.62)	178 (7.00)	178 (7.00)	3.76 (0.148)	11
10	273.0 (10.75)	216 (8.50)	216 (8.50)	4.19 (0.165)	16
12	323.8 (12.75)	254 (10.00)	254 (10.00)	4.57 (0.18)	28
14	355.6 (14.00)	279 (11.00)	279 (11.00)	4.78 (0.188)	-
16	406.4 (16.00)	305 (12.00)	305 (12.00)	4.78 (0.188)	-

### PERMITTED VARIATIONS IN WALL THICKNESS

NPS Designator	Tolerance, % from Nominal	
	Over	Under
1/8 to 2 1/2 incl., all t/D ratios	20.0	12.5
3 to 18 incl., t/D up to 5 % incl.	22.5	12.5
3 to 18 incl., t/D > 5%	15.0	12.5

where:

t = Nominal Wall Thickness

D = Ordered Outside Diameter

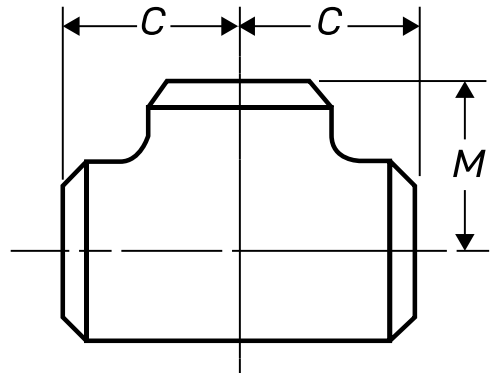

Fiorella Representaciones S.A.C.  
 Importador y distribuidor autorizado de productos HGA  
 para Perú y para su exportación.

\* Conversion equivalents are approximate. Reference weights.

\* Photos and reference data. Reference weights. We accept no liability for incorrect uses or misinterpretations of this data.

