



## BUTTERFLY FLANGED DUCTILE IRON A536 200 PSIG

Body of Ductile Iron A536

Designed in accordance with API 609

Face to Face API 609

Flange Connections: ANSI/ASME B16.5 RF class 150

Mounting actuator ISO 5211 adaptable

Disk stainless steel CF8M (316)

Bipartite Shaft

Seat elastometric: EPDM

Maximum working pressure:

200 PSIG size 2" - 12"

150 PSIG size 14" - 24"

Maximum temperature operation:

EPDM -18°C (0°F) to 110°C (230°F)

Featuring Memoryseal seating technology

Operation Lever or Gearbox

Square Shaft for mounting Lever or Gearbox

Hidrostatic test API 598

Diameters: 2" to 24"

NOTE: Soft seated valves are not recommended for steam service, hot and abrasive fluids.

\* Certification pending to norm API 609 from American Petroleum Institute



\* Reference photo



# BUTTERFLY FLANGED DUCTILE IRON A536 200 PSIG

## MATERIALS

	PART NAME	MATERIAL
1	STEM	STAINLESS STEELSS 410
2	BODY	DUCTILE CAST IRON ASTM A536
3	DISK	CF8M
4	SEAT	EPDM
5	END CAP	DUCTILE CAST IRON ASTM A536
6	BOLT	STEEL
7	TAPER PIN	SS 304 or SS316
8	O-RING	EPDM
9	BUSHING	PTFE
10	KEY	CARBON STEEL

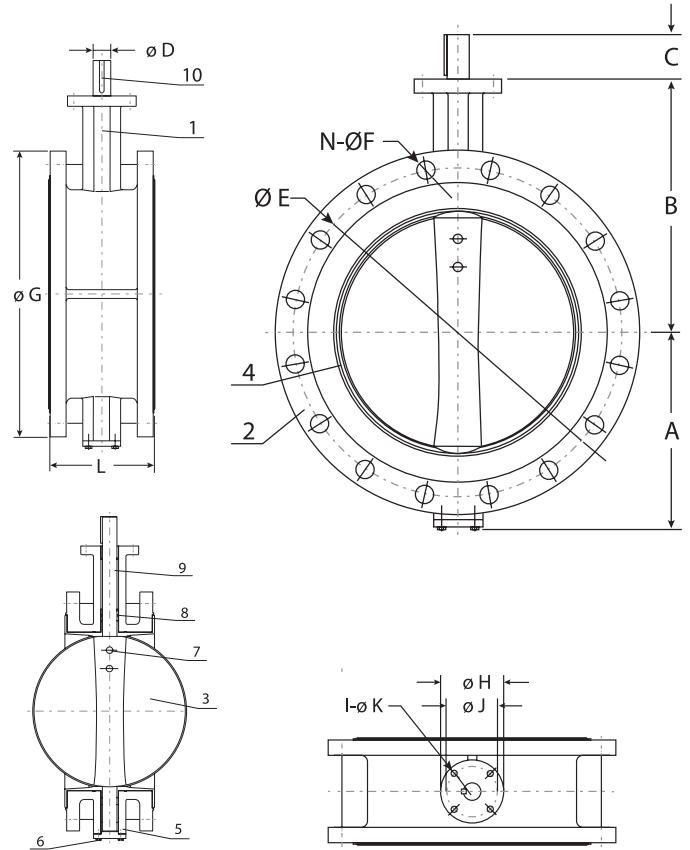

TEST API 598

## DIMENSIONS (mm)

SIZE	A	B	C	D	E	N-F	G	H	J	I-K	L	WEIGHT (Kg)
2"	70	130	32	12.7	120.7	4-19	152	90	70	4-9.5	108	9.98
2 1/2"	75	140	32	12.7	139.7	4-19	178	90	70	4-9.5	112	10.88
3"	85	150	32	12.7	152.4	4-19	191	90	70	4-9.5	114	12.70
4"	104	160	32	15.9	190.5	8-19	229	90	70	4-9.5	127	15.87
5"	112	180	32	19.1	215.9	8-22	254	90	70	4-9.5	140	20.41
6"	130	200	32	19.1	241.3	8-22	279	90	70	4-9.5	140	26.76
8"	160	230	38	22.2	298.5	8-22	343	125	102	4-11.5	152	31.75
10"	194	260	38	28.6	362	12-25	406	125	102	4-11.5	165	59.86
12"	220	300	38	31.8	431.8	12-25	483	125	102	4-11.5	178	80.73

\* Note : Dimensions, design and materials are subject to change without notice.